

**Addendum No. 2
December 4, 2018**

Project: Rock Valley Event Center and City Hall Remodel
Rock Valley, Iowa
Project number 1130.2762.17

Architect: Architecture Incorporated

Letting: December 11, 2018 at 2 PM
Rock Valley City Hall
1507 Main Street
Rock Valley, Iowa

Scope of this Addendum:

To all bidders and all others to whom drawings and specifications have been issued by Architecture Incorporated, this Addendum forms a part of the Contract Documents. Acknowledge receipt of this addendum by listing its number and date in the bidder's Form of Proposal. Failure to do so may subject bidder to disqualification. This addendum modifies the drawings and specifications as follows:

GENERAL ITEMS:

1) SPECIFICATION SECTION 033000 – CAST-IN-PLACE CONCRETE

- a) Page 9, paragraph 2.13.A Footings and Foundation Walls: Normal-weight concrete.
 - 1) Change Minimum Compressive Strength to 3000 psi at 28 days.

2) SPECIFICATION SECTION 042000 – UNIT MASONRY ASSEMBLIES

- a) Page 18, paragraph 3.12.A Field Quality Control – The Owner (not the General Contractor) will engage qualified independent inspectors to perform inspections and prepare reports.

3) SPECIFICATION SECTION 087100 – DOOR HARDWARE

- a) Page 13, paragraph 2.19 KEY CONTROL SYSTEM. Add paragraph B.
- b) B. Lock Box: Secure key lock box to store keys and access cards.
 - i) Basis of Design: KnoxBox 3200 Series, #3275 Recessed Mount.
 - (1) Finish: Dark Bronze
 - (2) Quantity: One.
 - ii) Install as directed by the Owner in new exterior veneer wall or column.

4) SPECIFICATION SECTION 092900 – GYPSUM BOARD

- a) Page 4. Add paragraph 2.8 Texture Finishes:

2.8 TEXTURE FINISHES

- (a) Primer: As recommended by textured finish manufacturer.
- (b) Non-Aggregate Finish: Water-based, job-mixed, aggregated, drying-type texture finish for spray application.
 - (i) Texture: [**Very light orange-peel spatter**]. Submit sample for approval.

- 1. Unless indicated otherwise, apply to all interior gypsum board surfaces except:

- a. Soffit and ceiling surfaces shall be smooth finish (no texture).
 - b. Surfaces scheduled to receive wallcover shall be smooth finish (no texture).
 - (ii) Coordinate final decoration of all exposed gypsum board surfaces with Architect prior to application of texture(s).
 - b) Page 8, paragraph 3.8.D.3: Provide Level 4 finish at Operable Partition Pockets/Closets.
 - c) Page 8, add to Level 4 finish:
 - b) Provide very light texture to new walls. Provide smooth finish at soffits and ceilings.
 - (a) Provide two (2) coats of primer at all gypsum board surfaces that are scheduled to remain exposed to view.
 - 1. Work of this Section shall include application of one (1) coat of [**drywall primer**] to all gypsum board surfaces prior to the application of paint decoration.
 - a. Apply to gypsum board surfaces according to drywall primer manufacturers written installation instructions.
 - b. Basis-of-Design Product: [**USG Sheetrock Brand – First Coat Primer**].
 - 2. A second coat of primer shall be applied to pre-primed gypsum board surfaces prior to application of paint decoration, as specified in Section 099123 "Interior Painting"; second coat of primer shall be the responsibility of Section 099123.
- 5) DRAWING 2.30 – SITE LAYOUT
 - a) Reference attached drawing Sheet 1 – Addenda #2 – West Tile Line dated 12-4-18 for drain tile on the north and south side of Vestibule 101. Connect drain tile to the storm pipe as shown.
- 6) DRAWING 4.20 – FLOOR PLAN
 - a) Patio 105 and Patio 106 – Extend the stairs and associated stair stoop to the wall at each Patio to eliminate the 6-inch gap between the patio wall and the stairs.
- 7) DRAWING 4.30 – FINISH PLAN & ROOM FINISH SCHEDULE
 - a) Room Finish Schedule Clarification: The abbreviation “DRF” in the ceiling column stands for Dry Fog / Fall Paint Specified in Section 099123 – Interior Paint. Interior Finishes specified in this Section shall be furnished and installed by the Owner.
- 8) DRAWING 5.40 – ROOF PLAN
 - a) Replace existing roof drains as noted in the Mechanical Items. Patch roofing and tectum deck as required for roof drain removal and installation.

MECHANICAL ITEMS:

SPECIFICATION ITEMS:

Replace paragraph 7 in section 230800 – 1.04 – ROOFTOP AIR CONDITIONING UNITS (2-15 TON SIZE) as follows:

The cabinet shall be galvanized steel with a paint finish or baked enamel. Cabinet panels where conditioned air is handled shall be fully insulated to prevent sweating and minimize sound. Openings shall be provided for power connection entry. Base shall have drainage holes. Lifting lugs shall be provided for rigging. All components, wiring and inspection areas shall be completely accessible through removable panels. Condenser coils shall be protected from hail.

DRAWING ITEMS:

DRAWING SHEET 8.22, Revision 1, Dated 11-29-18

1. Provide and install two 4” roof drains. Install in existing locations and connect to existing piping.

APPROVALS:

The following material or equipment furnished by the manufacturer's listed, may be substituted as equivalent providing that each item, material, and piece of equipment conforms to the design and requirement of the drawings and specifications.

<u>SECTION</u>	<u>ITEM</u>	<u>MANUFACTURER</u>
230800	Kitchen Hood	Captiveaire
261450	Lighting Controls	<i>See Below:</i>
	Relay Panel	Eaton, Touche
	Dimming Panel & Wall Stations	Touche
	Touch Screens & Photo Sensor	Greengate
	DMX Interface	Pathway
265119	Light Fixtures	<i>See Below:</i>
	Type C2	Acuity, Aculux
	Type P	Portfolio
	Type P1	SSL
	Type P2x	Lumos
	Type R	LED Linear
	Type S	Lithonia, Barron
	Type W, WE & W1	Ligman, Atlantic
	Type AA	Antique Street

END OF ADDENDUM

Plot Date: ----

13TH AVENUE
(ACC)

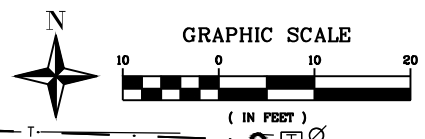

6"x4" TEE CONNECTING
TO 6" PVC SDR-26

EXISTING BUILDING
FFE=1256.0

- P-8: 14 LF OF 4" HDPE DUAL WALL PERFORATED DRAIN TILE BACKFILLED IN PEA ROCK
- P-9: 29 LF OF 4" HDPE DUAL WALL PERFORATE DRAIN TILE BACKFILLED IN PEA ROCK

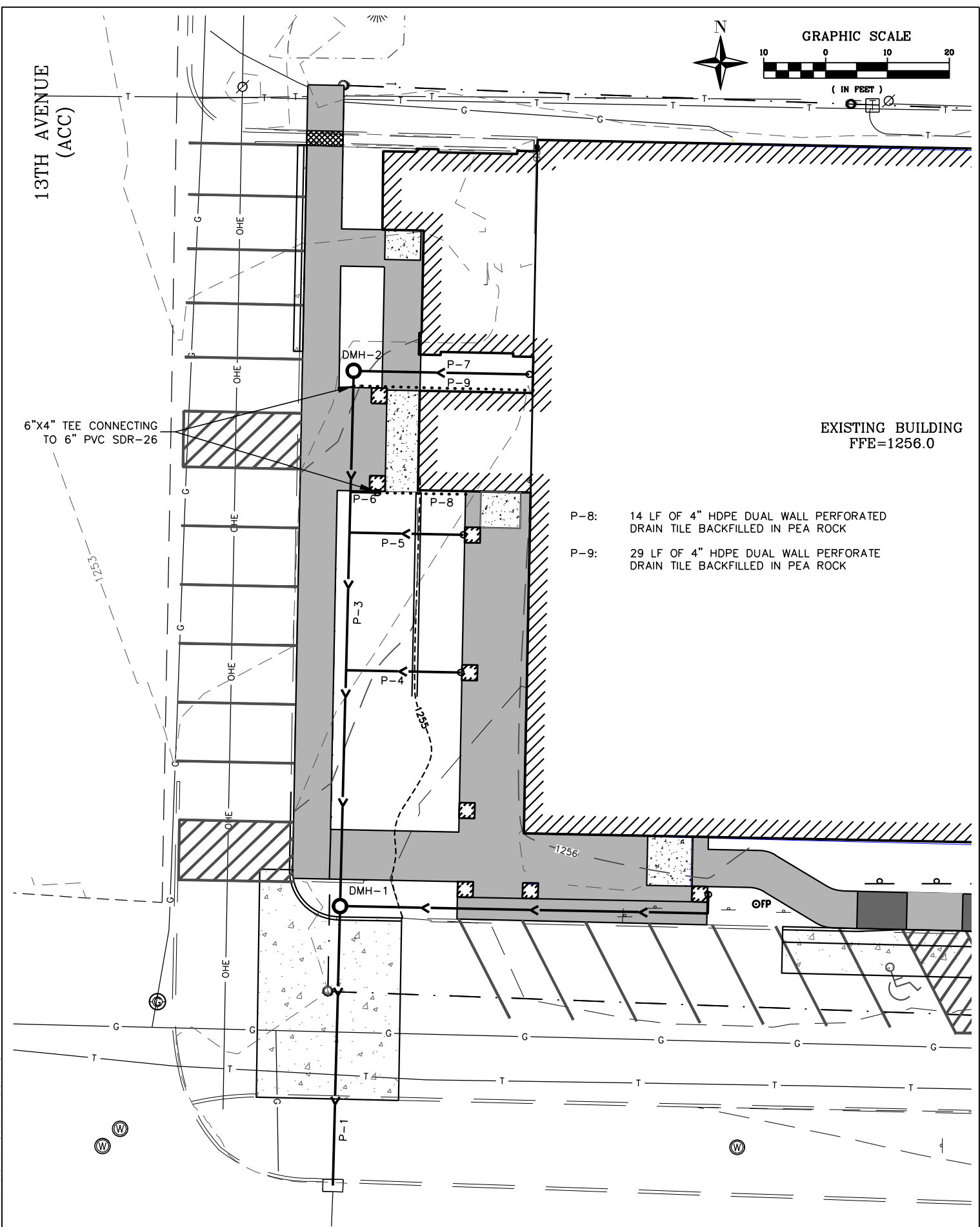

P:\03068217\568217.DWG:568217 DESIGN.DWG

REV	DATE	DESCRIPTION
1	12-4-18	ADDENDA #2



Project Manager: JPC
 Designer: MDK
 Project Number: 1130.2762.17
 Phone: (712) 472-2531

EVENT CENTER/CITY HALL
 ROCK VALLEY, IA

ADDENDA #2 - WEST TILE LINE

S
H
E
E
T

1